

QUANTITIES

684 L.F.	DUCTILE IRON PIPE
2 EA.	6" X 6" TEE
2 EA.	6" GATE VALVE W/BOX
2 EA.	SHORT SERVICE
41.7 S.Y.	PAVEMENT REPAIR

- NOTES:
1. ALL DRIVES ARE CONCRETE UNLESS NOTED OTHERWISE.
 2. ALL UTILITIES WERE NOT LOCATED BY THIS SURVEY.
 3. FIRE HYDRANT ASSEMBLY CONSISTS OF A 6" X 6" TEE, 6" GATE VALVE WITH BOX, AND FIRE HYDRANT.

SECTION 6, T1S, R7W, 14M,
STEPHENS COUNTY, OKLAHOMA.

UTILITY WARNING:
THE UNDERGROUND UTILITIES SHOWN HAVE BEEN LOCATED FROM FIELD SURVEY INFORMATION AND EXISTING RECORDS. THE SURVEYOR HAS NOT BEEN ADVISED OF ANY CHANGES IN THE LOCATION OF ANY UTILITIES SINCE THE DATE OF THE SURVEY. THE EXACT LOCATION INDICATED AS POSSIBLE FROM THE INFORMATION AVAILABLE. IT IS THE CONTRACTOR'S RESPONSIBILITY TO LOCATE ALL UNDERGROUND UTILITIES PRIOR TO COMMENCING WORK.

- LEGEND
- CONCRETE
 - EXISTING UNDERGROUND ELECTRICAL LINE
 - WATER SERVICE & METER
 - STORM SEWER MANHOLE
 - WATER LINE
 - EXISTING GAS MAIN
 - EXISTING UNDERGROUND TELEPHONE LINE
 - OVERHEAD POWERLINE
 - POWERPOLE
 - LIGHT POLE
 - BENCHMARK
 - EXISTING CONTOUR & ELEVATION
 - LOT NUMBER
 - BLOCK NUMBER
 - TREE
 - FIRE HYDRANT
 - SIGN
 - WATER VALVE
 - ELECTRIC MANHOLE
 - FENCE
 - MALIBOX
 - TELEPHONE JUNCTION BOX
 - EXISTING SANITARY SEWER MANHOLE & MAIN
 - EXISTING WATER MAIN

SCALE

PLAN VIEW: 1" = 30'
PROFILE VIEW: 1" = 3'
HORIZONTAL: 1" = 30'
VERTICAL: 1" = 3'

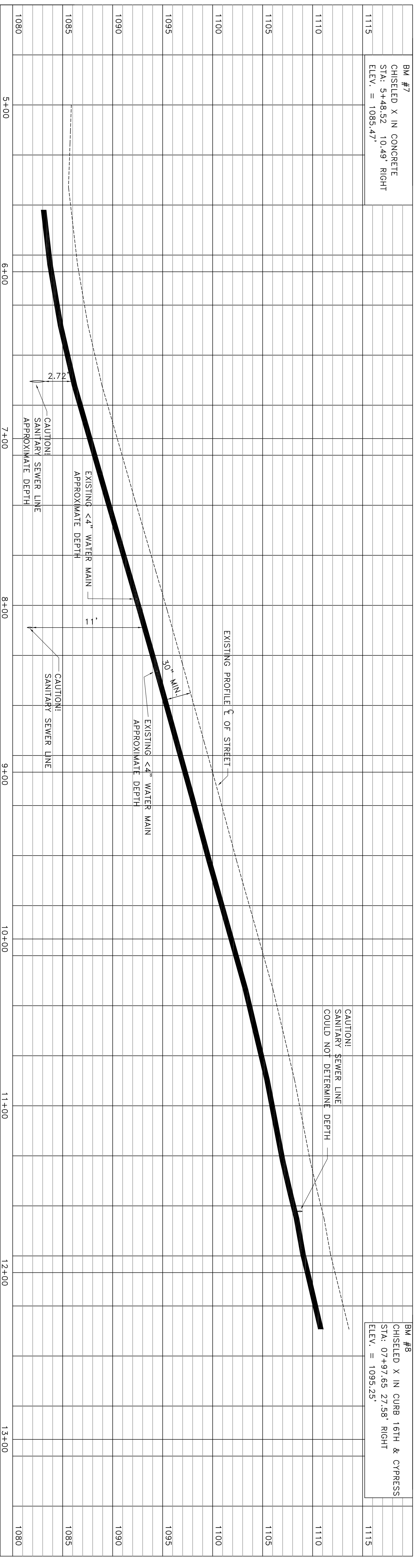

BN #8
CHISELED X IN CURB 16TH & CYPRESS
STA: 07+97.65 27.58' RIGHT
ELEV. = 1095.25'

BN #7
CHISELED X IN CONCRETE
STA: 5+48.52 10.49' RIGHT
ELEV. = 1085.47'

CITY OF DUNCAN
WATERLINE IMPROVEMENTS
0809

PLAN & PROFILE

PROJECT # 14888-81
SCALE: 1" = 30'
SURVEYED: 04-27-10
DRAWN: 11-04-10
DRAWN BY: BJP

REVISIONS:
1) 01-17-11/BJP
2)
3)
4)

SHEET NO. 7 OF 13

M. J. LEWIS & ASSOCIATES, INC.
(CA 1120) EXP. 06-30-11
707 WEST WALNUT AVENUE
DUNCAN, OKLAHOMA 73533
580-255-6402 - fax 580-470-8474 - toll free 877-606-5000
mjlewis1087@sbcglobal.net

MJLA
Surveying - Drafting - Design